

# PLAT OF SURVEY

## LOT 57 OF STONE RIDGE, A SUBDIVISION

LOCATED IN PART OF THE SE 1/4 OF THE SW 1/4 & SW 1/4 AND SE 1/4 OF THE SE 1/4 OF SECTION 24 AND IN PART OF THE NE 1/4 AND NW 1/4 OF THE NW 1/4 & NE 1/4, NW 1/4, SW 1/4, AND SE 1/4 OF THE NE 1/4 OF SECTION 25, ALL IN TOWN 2 NORTH, RANGE 17 EAST, CITY OF LAKE GENEVA, WALWORTH COUNTY, WISCONSIN

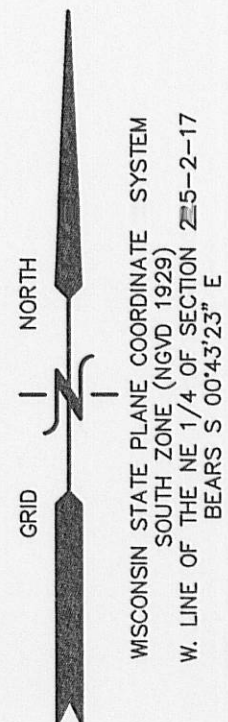

STONE RIDGE DRIVE  
60' WIDE PUBLIC R.O.W.

EXISTING STORM SEWER  
EXISTING SANITARY SEWER  
EXISTING WATERMAIN

N 09°48'31\"/>

10' WIDE UTILITY EASEMENT  
UTILITY BOXES

LOT 57  
13,931 S.F.

N 80°11'29\"/>

LOT 58

LOT 56

S 80°11'29\"/>

20' WIDE STORM SEWER & DRAINAGE EASEMENT  
S 00°22'31\"/>

UNPLATTED LANDS

STONYBROOK TRAIL  
60' WIDE PUBLIC R.O.W.

### LEGEND

- = FOUND IRON REBAR STAKE
- {xxx} = RECORDED AS
- X = EXISTING WATER VALVE
- ⊗ = EXISTING HYDRANT W/ VALVE

NOTE: COPIES OF THIS MAP TO WHICH THE FOLLOWING CERTIFICATE WILL APPLY SHOW SURVEYOR'S ORIGINAL SEAL AND SIGNATURE IN RED INK. COPIES BY ANY OTHER MEANS MAY HAVE ALTERATIONS WHICH DO NOT REPRESENT THE SURVEYOR'S WORK PRODUCT.

I HEREBY CERTIFY THAT THE ABOVE DESCRIBED PROPERTY HAS BEEN SURVEYED UNDER MY DIRECTION AND THAT THE ABOVE MAP IS A TRUE REPRESENTATION THEREOF AND SHOWS THE SIZE AND LOCATION OF THE PROPERTY, ITS EXTERIOR BOUNDARIES, THE LOCATION OF ALL VISIBLE STRUCTURES, AND DIMENSIONS OF ALL PRINCIPLE BUILDINGS THEREON, BOUNDARY FENCES, APPARENT EASEMENTS, ROADWAYS, AND VISIBLE ENCROACHMENTS, IF ANY. THIS SURVEY IS MADE FOR THE USE OF THE PRESENT OWNERS OF THE PROPERTY, AND ALSO THOSE WHO PURCHASE, MORTGAGE, OR GUARANTEE THE TITLE THERETO WITHIN ONE YEAR FROM THE DATE HEREOF.

DATED: NOVEMBER 28, 2005

RESURVEYED AND RECERTIFIED 02-18-2011

*Peter S. Gordon*  
PETER S. GORDON R.L.S. 2101

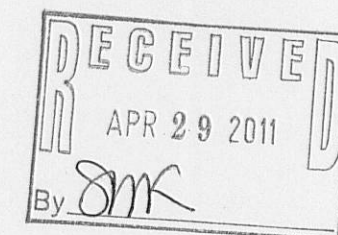

FARRIS, HANSEN & ASSOCIATES, INC.  
ENGINEERING - ARCHITECTURE - SURVEYING  
7 RIDGWAY COURT P.O. BOX 437  
ELKHORN, WISCONSIN 53121  
OFFICE: (262) 723-2098 FAX: (262) 723-5886

WORK ORDERED BY -  
FAIRWYN, LTD.  
851 PARK DRIVE SUITE 104  
LAKE GENEVA, WI 53147

PLAT OF SURVEY

PROJECT NO.  
6041.57  
DATE:  
11/28/2005  
SHEET NO.  
1 OF 1

REVISIONS

